

ALMA

YOUR ARCHITECTURAL SANCTUARY



A RESIDENTIAL HAVEN FOR THE SOUL

Set amongst the lush, breathtaking scenery of Huatulco, Oaxaca, ALMA is a residential complex with a premium yet understated edge that calls to those seeking a balance of nature and signature modern architecture.

Nestled between the mountains and the sea, ALMA will gently stroke your senses with its warm blend of minimalism and well-being.

CONTENT

Genesis

Huatulco

The lot

Architecture

Sustainability

Master plan

Properties

Material palette

Amenities

Team

Disclaimers

THE FUSION OF ARCHITECTURE AND NATURE



ALMA was born from a desire to demonstrate that it is possible to develop an environmentally respectful residential complex while promoting modern architecture.

We believe that architecture is not simply about designing a space or a monument. It is not material. Rather, it is an experience that adapts to the surroundings and enhances your well-being. With this in mind, ALMA has been designed to uplift you from your first step within.

We also believe that architecture and nature should underscore each other. And to us, nature is about knowing that Oaxaca accounts for half of Mexico's biodiversity and doing our very best to maintain it by reducing our overall impact, favoring endemic species, preserving trees, and raising awareness among our owners and renters about the treasure that will surround them at ALMA.

While this vision may seem ambitious, we are convinced it will elevate how one experiences life in the tropics.

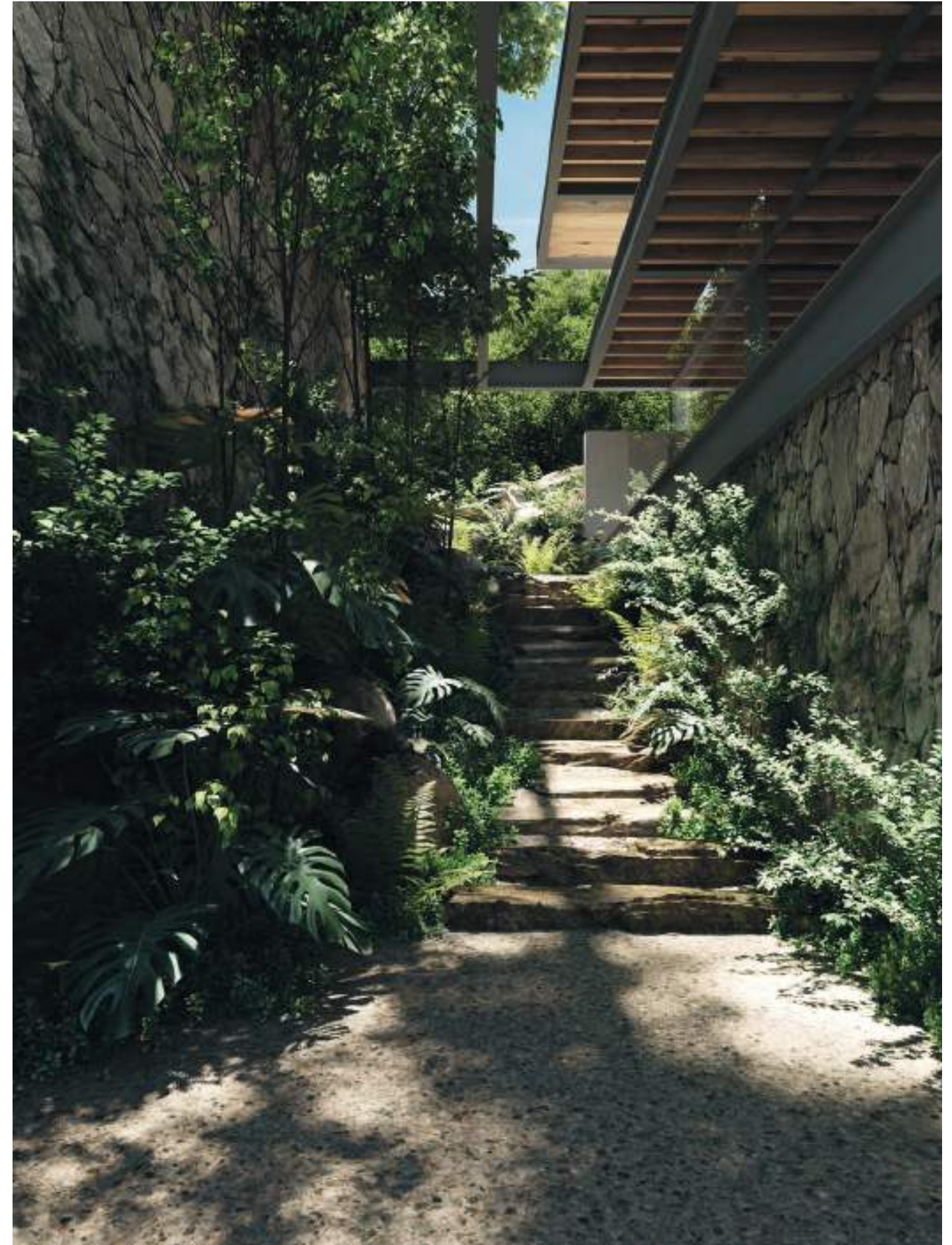

HUATULCO, THE HIDDEN GEM OF
MEXICO'S PACIFIC COAST



Huatulco is an unspoiled gem that blends pristine beaches, majestic mountains and abundant biodiversity, only 15 minutes away from an international airport, making it a prime destination for real estate investment.

BAHÍAS DE HUATULCO

The coastal haven of Bahías de Huatulco spreads onto **9 bays** and boasts **36 beaches**, many of which are only accessible by boat. Visitors come to explore the depths of its natural beauty and enjoy its relaxed atmosphere.

NATURE ENCLAVE

ALMA stands at its heart and at the doorstep of its national park. Wake up to the sights and sounds of nature from the comfort of your home, and in just minutes, reach the vibrant town center of Huatulco.



International Airport

ALMA

Santa Cruz
 Conejos
 Tangolunda
 Chahue
 Órgano
 Cacaluta
 Chachacual
 Riscalillo
 San Agustín
 La Bocana
 Mexico City
 Huatulco

Bahías de Huatulco, Oaxaca, Mexico.



A VISION FOR A SUSTAINABLE FUTURE

Huatulco is committed to sustainable tourism and development. It is dedicated to preserving its natural beauty and resources, ensuring that future generations can enjoy its stunning landscapes and pristine beaches. It makes it an ideal destination for investors who care about their legacy for future generations.

70%

Of Huatulco's area is preserved as natural space

6,300+

The city comprises a national park of over 6,300 ha. of land (15,000 ac.)

400+

Species of animals and around 700 species of plants

90%

Of the city's electricity comes from renewable sources

100%

Of the grey water of the city is treated and reused for its green spaces

1ST

City in the world to obtain the Earth Check Master certification



A GROWING MARKET

Whether looking for an investment property, a second home or a place to retire, its enchanting beauty makes it a prime destination for those seeking to invest in a safe and booming market.

A THRIVING TOURIST DESTINATION

Huatulco attracts visitors from all over the world. It is teeming with a diverse range of outdoor activities such as diving, hiking, surfing, river rafting, bird watching or whale watching.



330 DAYS OF SUN PER YEAR



28°C / 82°F AVERAGE YEARLY TEMPERATURE



OCEAN & MOUNTAIN ACTIVITIES



TWO MARINAS



BEACHFRONT 18 HOLE GOLF COURSE



PRIVATE LAND OWNERSHIP



WHALE MIGRATION



FAMOUS SURF PIPE



MEXICO CANADA UNITED STATES

THE LOT

ALMA is nestled in an area of Huatulco that reflects its very essence —abundant nature. It sits on a south-facing 3.6 ha (9 acres) lot comprised of two small hills that gently make their way down to the ocean, guaranteeing a variety of distinct sea views from the properties.

While seemingly secluded, it is just a few minutes from La Crucecita and 20 minutes from an international airport. Positioned at the doorstep of the National Park, surrounded by miles of biking lanes, and close to world-class amenities, you are guaranteed to return home filled with peace every time you step out.

ALMA's adjacent lots to the east will be developed with the same vision in mind, so you can rest assured that the environment, neighborhood, density, views, architectural style, and natural beauty will be carefully controlled and preserved.

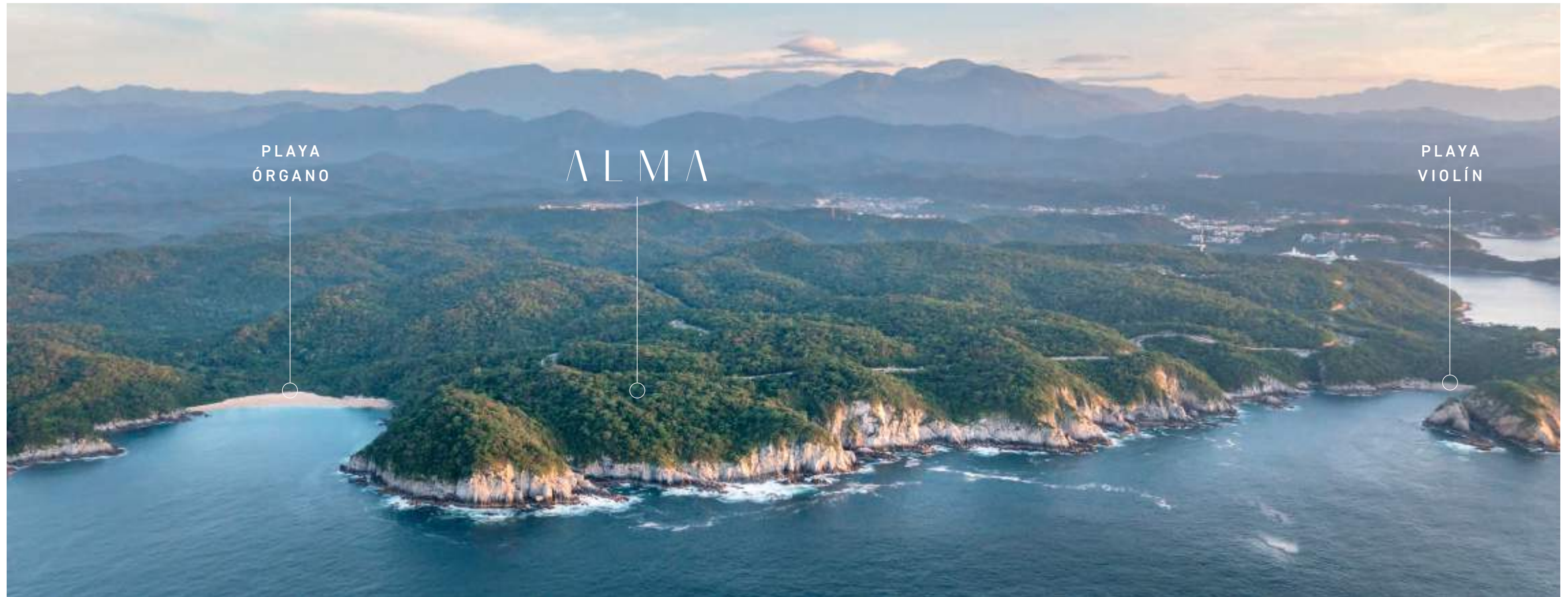

BLURRING THE BOUNDARIES BETWEEN
THE INDOORS AND OUTDOORS





ALMA's architectural environment underscores its spectacular surroundings and truly focuses on views, nature, silence, intimacy, and space, offering a one-of-a-kind residence that elevates your living experience in Huatulco.

Jose Juan Rivera Río (JJRR/Arquitectura), who is recognized for his timeless designs, imposed himself as the perfect choice. With a deep respect for the surrounding environment and a dedication to enhancing personal well-being, he designed the 46 signature properties that compose ALMA in collaboration with Módica-Ledezma.

The residence unobtrusively combines Mexican architecture with the raw beauty of the Pacific coastline, embracing you in its breathtaking landscape. Pure lines impart a sense of weightlessness to the design, enhanced by floor-to-ceiling sliders that blur the boundary between the indoors and outdoors while preserving comfort.

With perfectly framed ocean views, each property also provides shade essential in these latitudes.

When you've experienced crowded destinations or overwhelming spaces, you know that true luxury lies in delicately balancing space, privacy, and peace. This is why we have created an architectural environment that underscores its spectacular surroundings and truly focuses on views, nature, silence, intimacy, and space.

Steel, glass, and wood blends are used as primary materials to give ALMA a tropical but modern feel. Mosquito screens provide evening comfort without disrupting the impression of living on a terrace.



INSPIRED BY NATURE

We firmly believe that architecture has to honor nature rather than reshape it. Our approach reflects a deep respect for the environment, focusing on low-density sustainable development.



As much as ALMA is about creating beautiful spaces, it is also about being good stewards of the land that hosts it.





All our properties incorporate state-of-the-art solutions to make them not only the most pleasant of places but also the most environmentally respectful and climate responsive.

- 1 ENERGY EFFICIENCY & SUSTAINABLE COOLING**

 - + Vegetal roofs reduce the upper floor temperature by up to 4°C (7°F).
 - + Stack and cross ventilation from the Pacific Ocean contribute to natural cooling of the first floor.
 - + Large covered terraces provide shade, naturally reducing the temperature on all floors.
 - + A pool located in front of the living room contributes to cooling the air entering the property from the south.
- 2 LOCAL, DURABLE AND SUSTAINABLE MATERIALS**

 - + Stone from the lot, Wood, Steel, National marble Glass (=no paint).
- 3 POOL**

 - + Saltwater instead of chlorine to promote health.
- 4 CARE FOR ENDEMIC SPECIES**

 - + Preservation and/or relocation of the most remarkable trees on the lot.
 - + Relocation of protected species of flora found on the lot.
 - + Planting a majority of endemic species in the residence's landscaping.
 - + Utilization of vegetated roofs to enhance pollination.
 - + Low-density development to optimize the presence of endemic species and overall greenery.
- 5 MINIMIZATION OF WATER FOOTPRINT**

 - + Reusing treated domestic water for toilet flushing.
 - + Treating all greywater from the residence.
 - + Landscaping predominantly composed of endemic species that are more drought-resistant, reducing irrigation needs.
 - + Partial shading above the pools to help minimize evaporation
- 6 WASTE SORTING**

 - + In every unit, in a dedicated ventilated area.
- RENEWABLE ENERGIES**

 - + Used on carports to provide backup system for the residence.
- MINIMIZING VISUAL IMPACT**

 - + Following the natural topography of the lot.
 - + Green roofs to minimize the built views.
 - + Glass sliders instead of solid.
 - + Horizontal architecture instead of vertical.
 - + Low-density, low-rise design.

FIND THE PERFECT AMBIANCE

All 46 signature properties provide a unique ambiance by accounting for the lot's distinct views and atmospheres.

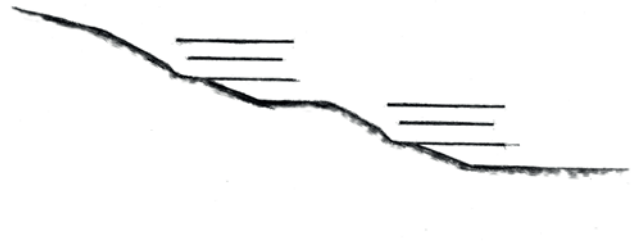

LOW DENSITY MASTER PLAN

With a density of only 13 units per hectare (or 5.2 per acre), ALMA currently features the lowest density on the market. ALMA's architects have also "listened" to the topography, placing villas in natural positions around the hills and minimizing street sizes.

The master plan is thus composed of four main clusters that mix condos and villas with views to the southeast, south, and southwest.



46

PROPERTIES

4

TWO-BEDROOM CONDOS

6

THREE-BEDROOM CONDOS

22

THREE-BEDROOM VILLAS

14

FOUR-BEDROOM VILLAS

SHARED AMENITIES

SWIMMING SALT POOLS

WELLNESS CENTER

HYDRO-MASSAGE POOL

FULLY EQUIPPED GYM

CONCIERGE DESK

LUXURY SHUTTLE



YOUR OWN PRIVATE HAVEN

ALMA is intentionally built to be enjoyed 365 days a year. Its blend of indoor and outdoor living is particularly appealing to those who wish to live in Huatulco for extended periods —in any season.



46

Villas & Condos on the oceanfront, climate responsive and adapted to your needs.

- Ocean views
- Large covered terraces
- Glass sliders on 3 sides
- Mosquito nets
- Direct covered parking
- Enhanced privacy
- Infinity pools in every villa

VILLAS
ALMA's villas are generously spacious with a modern design and offer luxury amenities well-suited to the tropical climate of Huatulco. Blurring the boundaries between the indoors and outdoors, they allow the ocean breeze, vegetation shade, and natural charm to enter the homes while framing spectacular ocean views and preserving intimacy.

CONDOS
ALMA's condos follow the same architectural language and features as the villas. Located in small buildings, they provide an ample, intimate living area and allow for an indoor-outdoor lifestyle with some of the most spectacular views in Huatulco.

4 BEDROOM
GRAND VILLAS



FIRST FLOOR

- DINING ROOM
- LIVING ROOM
- OUTDOOR SHOWER
- KITCHEN & PANTRY
- HALF BATHROOM
- COVERED TERRACE
- SWIMMING POOL



SECOND FLOOR

4

BEDROOMS
BATHROOMS

- LAUNDRY ROOM
- DOUBLE SHOWER
- COVERED TERRACES
- WALK-IN CLOSET



4 4.5 2

INDOOR AREA: 300 m² / 3,229 ft² TERRACE AREA: 135 m² / 1,453 ft² STORAGE ROOM: 23 m² / 247 ft²

TOTAL AREA: 435 m² / 4,683 ft² POOL AREA: 30 m² / 322 ft²

Some properties' access is located on the ground floor, and some on the upper floor. All properties come with covered direct parking, some of them at the basement level, some of them at the upper street level.

3 BEDROOM VILLAS



FIRST FLOOR

- DINING ROOM
- LIVING ROOM
- LAUNDRY ROOM
- KITCHEN
- HALF BATHROOM
- COVERED TERRACE
- SWIMMING POOL



SECOND FLOOR

3

BEDROOMS
BATHROOMS

- DOUBLE SHOWER
- COVERED TERRACES
- WALK-IN CLOSET



 3  3.5  1 to 2

INDOOR AREA: 200 m² / 2,135 ft²

TERRACE AREA: 98 m² / 1,055 ft²

STORAGE ROOM: 12 m² / 140 ft²

TOTAL AREA: 298 m² / 3,190 ft²

POOL AREA: 15 m² / 161 ft²

Some properties' access is located on the ground floor, and some on the upper floor. All properties come with covered direct parking, some of them at the basement level, some of them at the upper street level.

3 BEDROOM APARTMENT CONDOS



1 APT/FLOOR

3

BEDROOMS

3.5

BATHROOMS

- COVERED TERRACES
- LAUNDRY ROOM
- ELEVATOR

 3  3.5  1

INDOOR AREA: 170 m² / 1,830 ft² **TERRACE AREA:** 70 m² / 753 ft² **STORAGE ROOM:** 8 to 15 m² / 86 to 161 ft²

TOTAL AREA: 240 m² / 2,583 ft² **3 FLOOR BUILDING / 1 APARTMENT PER FLOOR**

Some properties' access is located on the ground floor, and some on the upper floor. All apartments come with covered direct parking next to or underneath their building.



2 BEDROOM APARTMENT CONDOS



2 APT/FLOOR

2

BEDROOMS

2.5

BATHROOMS

- COVERED TERRACES
- SOUTH FACING
- ELEVATOR

 2  2.5  1

INDOOR AREA: 130 m² / 1,400 ft² **TERRACE AREA:** 50 m² / 538 ft² **STORAGE ROOM:** 15 m² / 161 ft²

TOTAL AREA: 180 m² / 1,937 ft² **2 FLOOR BUILDING / 2 APARTMENT PER FLOOR**

Some properties' access is located on the ground floor, and some on the upper floor. All apartments come with covered direct parking underneath their building.



MATERIAL PALETTE

Earth tones and natural materials are dominant in ALMA. Stone from the land, steel beams, wooden beams, local marble, and local essence of trees blend in order to give ALMA a warm minimalist look, typical from the Mexican modern architectural movement.



MARBLE

A bright Mexican marble being used as the main material for the majority of floors, both indoor and outdoor, in order to enhance the sensation of blurred boundaries. It is luxury and extremely resistant, requiring little to no maintenance.



STONE

Most stones used in ALMA come from its own lot. Typical from Huatulco and recognizable for their light warm color, they will be used for all basements and separation walls.



CONCRETE

From Japan to the Americas and through Europe, concrete is a noble material often associated with minimalist architecture. Its grey color complements the other natural tones of the lot, both in the dry and the green seasons.



WOOD

Wood is key in ALMA's architectural style, and it perfectly harmonizes with the surrounding nature. Being both resilient and sustainable, it imparts a sense of warmth characteristic of tropical architecture.



STEEL

Gray steel beams are undeniably a prominent design element in Mexican modern architecture. Mixing them with wood and stone creates a minimalist yet inviting atmosphere, giving ALMA a distinctive Mexican identity.



VEGETATION

To ensure ALMA blends into the landscape when viewed from the ocean, a mix of endemic and national essences of vegetation is incorporated. This approach provides an all-year-green layer for the residents to enjoy, all while preserving biodiversity.

A REFUGE FROM THE PACE OF EVERYDAY LIFE

Shared amenities offer numerous ways to live a luxurious architectural experience defined by natural elegance and tranquility. From the swimming pools to the concierge service everything is made to ensure that ALMA is a place of well-being. For your privacy and comfort, only ALMA's owners and renters will have access to the residence and its amenities.



SWIMMING POOLS

Two iconic saltwater pools with sunbathing decks : A 33.3-meter-long and a 25-meter both offering perfect spots for relaxation.



CAR ACCESSIBILITY

Driving to properties and parking directly under or close to them is a rare convenience, so accessibility was prioritized in ALMA's design.



HYDRO-MASSAGE POOL

Find a hydro-massage pool near the gym for your ultimate relaxation.



CONCIERGE DESK

Experience personalized service with ALMA's dedicated concierge desk.



WELLNESS CENTER

Indulge in serenity at ALMA's semi-subterranean wellness center, embraced by lush vegetation, sauna, cold plunge, jacuzzi, and a massage area located in the heart of the residence.



PRIVATE SHUTTLE

Get to your nearby destination with ease even if you don't have a car.



GYM

For the active type find a fully equipped gym near the central swimming pool. Note: just outside the residence find 6 miles of dedicated running & biking lanes.

These amenities combined with its incredible location five minutes away from the town center, at the doorstep of the national park, will make this low-density signature development a rare find in the future.



COMMITTED TO REASONABLE PROPERTY DEVELOPMENT

ESENCIA DESARROLLOS

ALMA's development company, was created by a French couple passionate about architecture and nature. We are committed to creating spaces that enhance human well-being through modern, thoughtful, and site-sensitive architecture and design. We surround ourselves with the most passionate, ethical, and experienced professionals in the market. With a wealth of international experience in real estate, construction, architecture, and sustainability, our extended team brings a global perspective to our work in Huatulco.



JJRR/ARQUITECTURA

This firm's work is characterized by the elegant use of concrete, stone, and wood, as well as large glass extensions and open floors that blur the boundaries between the indoors and outdoors. His work was highlighted at the 2021 Architectural Biennale of Venice, standing out for his unique creative vision and continuous commitment to the environment.

MÓDICA LEDEZMA

The architectural firm based in Mexico City was founded by Héctor Módica and Carlos Ledezma. Their timeless designs enhance the living experience and their work system is centered around architectural detail in harmony with engineering, aiming to create environments that stimulate the senses.

RESORT REAL ESTATE

A team of experienced professionals, on the one hand, helps clients find properties that perfectly fit their lifestyle and budget. The team understands that buying or selling a home can be intimidating, especially if doing so remotely, and accordingly provides personalized services that take the stress out of a foreign real estate journey.

PROH CONSTRUCTORA

A Mexican/American team of experienced developers, engineers, and architects who share a passion for creating beautiful, unique, and functional tropical living environments. They nurture a deep enthusiasm for excellence in Huatulco, and their team offers a fresh, organized approach.



Renders and illustrations contained in this document are provided for information only and are not contractually binding. Views shown cannot be relied upon as the actual view from any particular unit or building. The master plan contained in this document is non contractual and is subject to change without notice. Floor plans contained in this document are non-contractual and are subject to change without notice. Consult your Agreement for the items included with the units, project, land, etc.

The developer expressly reserves the right to make modifications, revision and changes it deems necessary in its sole and absolute discretion and without notice.

All texts, illustrations, photos and images are the sole property of ©Esencia Desarrollos. Their use is strictly prohibited without the written consent of Esencia Desarrollos.

ALMA

BY ESENCIA DESARROLLOS

Camino escénico, Sector el Violín
70987 Bahías de Huatulco,
Oaxaca, México

 ALMA.HUATULCO

 ALMA-HUATULCO

W. ALMA-HUATULCO.COM



Exclusively offered by Resort Real Estate